



**PMC**

**INVEST**

**TIVAT**





**PMC**  
INVEST  
TIVAT





**PMC**  
INVEST  
TIVAT





**PMC**  
INVEST  
TIVAT



# GARAŽA

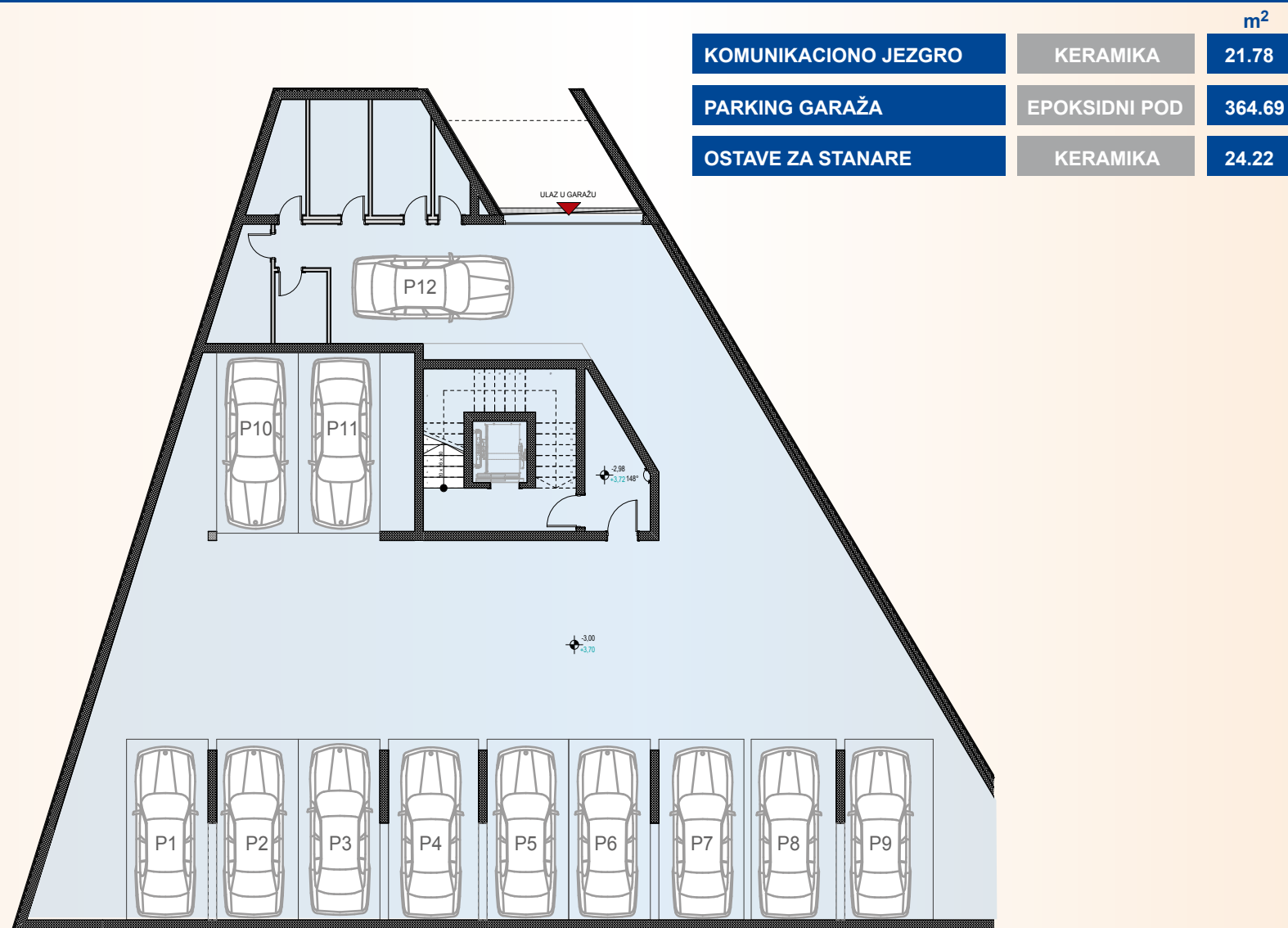

**PMC**  
INVEST  
TIVAT

# PRIZEMLJE - POSLOVNI PROSTORI

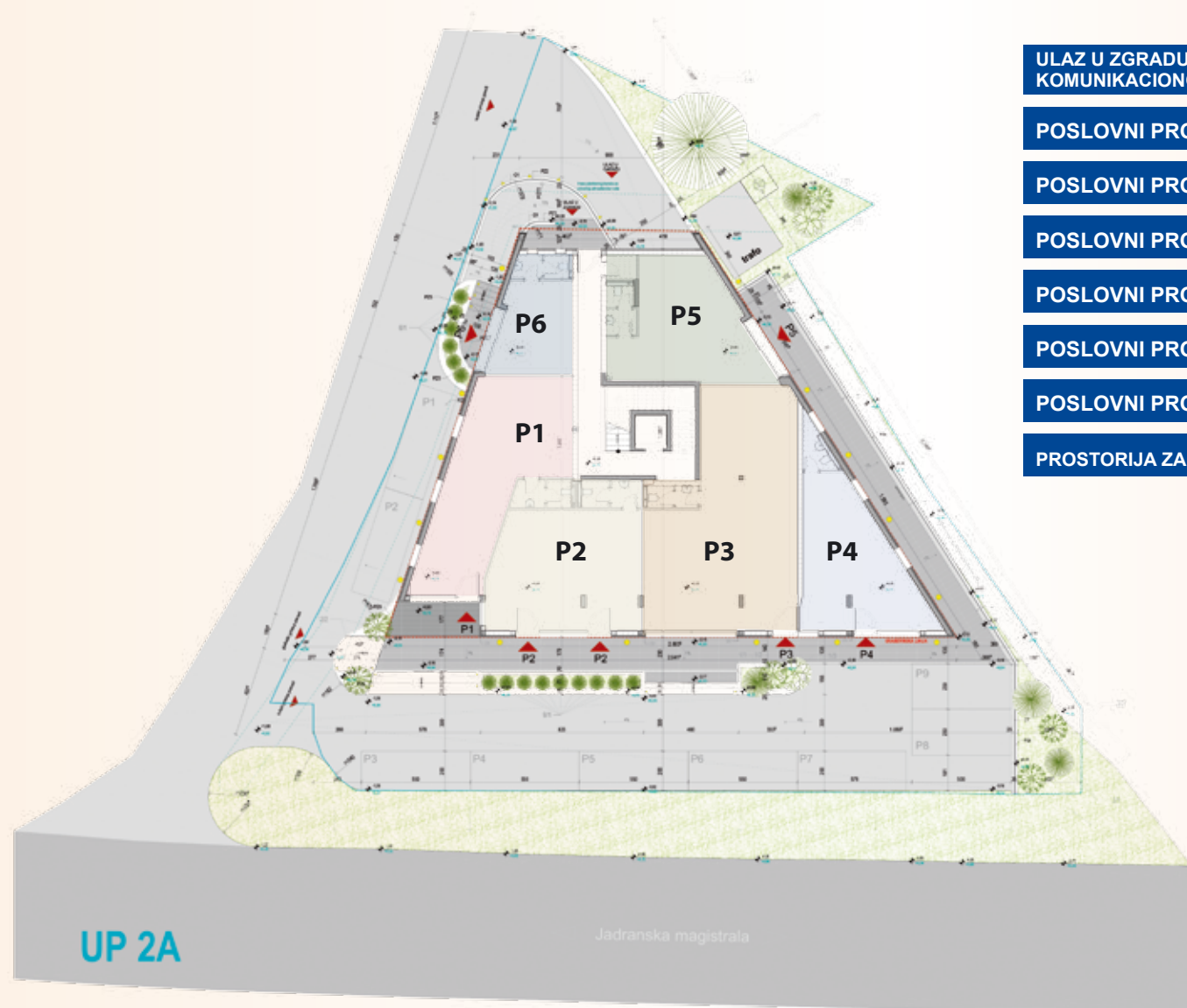

|                                      |          | m <sup>2</sup> |
|--------------------------------------|----------|----------------|
| ULAZ U ZGRADU I KOMUNIKACIONO JEZGRO | KERAMIKA | 30.31          |
| POSLOVNI PROSTOR 1                   | KERAMIKA | 53.74          |
| POSLOVNI PROSTOR 2                   | KERAMIKA | 49.72          |
| POSLOVNI PROSTOR 3                   | KERAMIKA | 81.16          |
| POSLOVNI PROSTOR 4                   | KERAMIKA | 40.15          |
| POSLOVNI PROSTOR 5                   | KERAMIKA | 40.47          |
| POSLOVNI PROSTOR 6                   | KERAMIKA | 20.64          |
| PROSTORIJA ZA VIDEO NADZOR           | KERAMIKA | 1.83           |



**PMC**  
INVEST  
TIVAT

# PRVI SPRAT

| S1 JEDNOSOBAN             |                     | 48.49 m <sup>2</sup> |
|---------------------------|---------------------|----------------------|
| Ulazni hodnik             | PARKET              | 6.30                 |
| Kupatilo                  | KERAMIKA            | 4.41                 |
| Kuhinja/trpezarija/dnevna | KERAMIKA/<br>PARKET | 24.94                |
| Spavaća soba              | PARKET              | 10.89                |
| Terasa                    | KERAMIKA            | 1.95                 |
| S2 DVOSOBAN               |                     | 84.23 m <sup>2</sup> |
| Ulazni hodnik             | PARKET              | 8.28                 |
| Toalet / vešeraj          | KERAMIKA            | 4.78                 |
| Kupatilo                  | KERAMIKA            | 3.92                 |
| Kuhinja/trpezarija/dnevna | KERAMIKA/<br>PARKET | 34.47                |
| Spavaća soba              | PARKET              | 11.87                |
| Spavaća soba              | PARKET              | 13.34                |
| Terasa                    | KERAMIKA            | 7.57                 |
| S3 JEDNOSOBAN             |                     | 54.60 m <sup>2</sup> |
| Ulazni hodnik             | PARKET              | 4.41                 |
| Kupatilo                  | KERAMIKA            | 4.02                 |
| Kuhinja/trpezarija/dnevna | KERAMIKA/<br>PARKET | 26.32                |
| Spavaća soba              | PARKET              | 12.40                |
| Terasa                    | KERAMIKA            | 7.45                 |

| S4 DVOSOBAN               |                     | 75.55 m <sup>2</sup> |
|---------------------------|---------------------|----------------------|
| Ulazni hodnik             | PARKET              | 8.06                 |
| Toalet                    | KERAMIKA            | 1.72                 |
| Kupatilo                  | KERAMIKA            | 3.56                 |
| Kuhinja/trpezarija/dnevna | KERAMIKA/<br>PARKET | 31.70                |
| Spavaća soba              | PARKET              | 11.90                |
| Spavaća soba              | PARKET              | 11.31                |
| Terasa                    | KERAMIKA            | 7.30                 |
| S5 JEDNOSOBAN             |                     | 38.45 m <sup>2</sup> |
| Ulazni hodnik             | PARKET              | 5.88                 |
| Kupatilo                  | KERAMIKA            | 3.75                 |
| Kuhinja/trpezarija/dnevna | KERAMIKA/<br>PARKET | 16.35                |
| Spavaća soba              | PARKET              | 7.67                 |
| Terasa                    | KERAMIKA            | 2.62                 |
| Predsoblje                | PARKET              | 2.18                 |

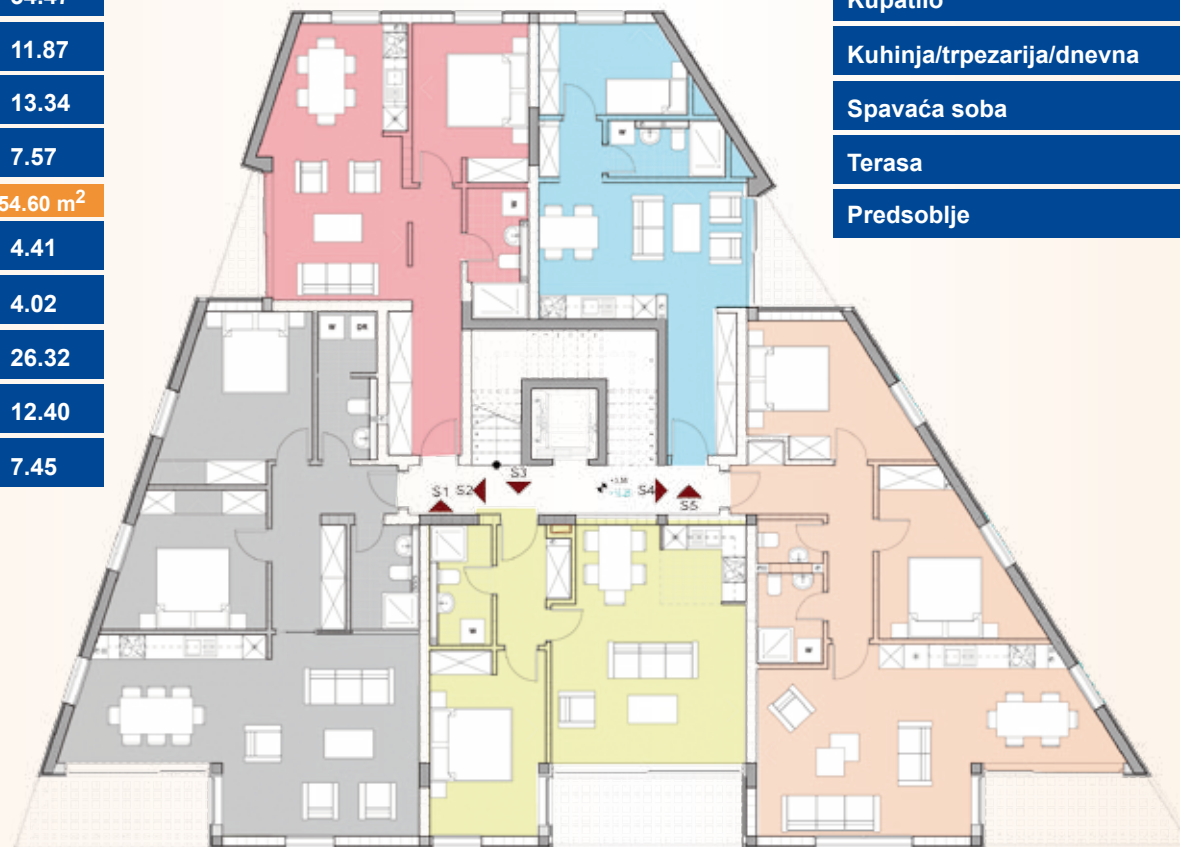

**PMC**  
INVEST  
TIVAT

| S6 TROSOBAN               |                     | 113 m <sup>2</sup>   |
|---------------------------|---------------------|----------------------|
| Ulazni hodnik             | PARKET              | 6.48                 |
| Toalet                    | KERAMIKA            | 1.79                 |
| Kuhinja/trpezarija/dnevna | KERAMIKA/<br>PARKET | 15.16                |
| Dnevna soba               | PARKET              | 27.85                |
| Hodnik - noćna zona       | PARKET              | 4.93                 |
| Kupatilo                  | KERAMIKA            | 5.48                 |
| Spavaća soba              | PARKET              | 9.57                 |
| Master spavaća soba       | PARKET              | 20.27                |
| Spavaća soba              | PARKET              | 11.32                |
| Garderober                | KERAMIKA            | 2.33                 |
| Terasa                    | KERAMIKA            | 7.82                 |
| S7 DVOSOBAN               |                     | 76.87 m <sup>2</sup> |
| Ulazni hodnik             | PARKET              | 10.24                |
| Toalet                    | KERAMIKA            | 2.52                 |
| Kuhinja/trpezarija        | KERAMIKA            | 12.26                |
| Dnevna soba               | PARKET              | 14.66                |
| Kupatilo                  | KERAMIKA            | 4.41                 |
| Spavaća soba              | PARKET              | 10.89                |
| Spavaća soba              | PARKET              | 18.96                |
| Kupatilo                  | KERAMIKA            | 2.93                 |

## DRUGI SPRAT

| S8 DVOSOBAN               |                     | 74.75 m <sup>2</sup> |
|---------------------------|---------------------|----------------------|
| Ulazni hodnik             | PARKET              | 8.06                 |
| Toalet                    | KERAMIKA            | 1.72                 |
| Kupatilo                  | KERAMIKA            | 3.67                 |
| Kuhinja/trpezarija/dnevna | KERAMIKA/<br>PARKET | 31.58                |
| Spavaća soba              | PARKET              | 11.90                |
| Spavaća soba              | PARKET              | 11.23                |
| Terasa                    | KERAMIKA            | 6.59                 |
| S9 JEDNOSOBAN             |                     | 39.41 m <sup>2</sup> |
| Ulazni hodnik             | PARKET              | 5.88                 |
| Kuhinja/trpezarija/dnevna | KERAMIKA/<br>PARKET | 16.35                |
| Predsooblje               | PARKET              | 2.18                 |
| Kupatilo                  | KERAMIKA            | 3.76                 |
| Spavaća soba              | PARKET              | 7.67                 |
| Terasa                    | KERAMIKA            | 3.57                 |



**PMC**  
INVEST  
TIVAT

# KROV

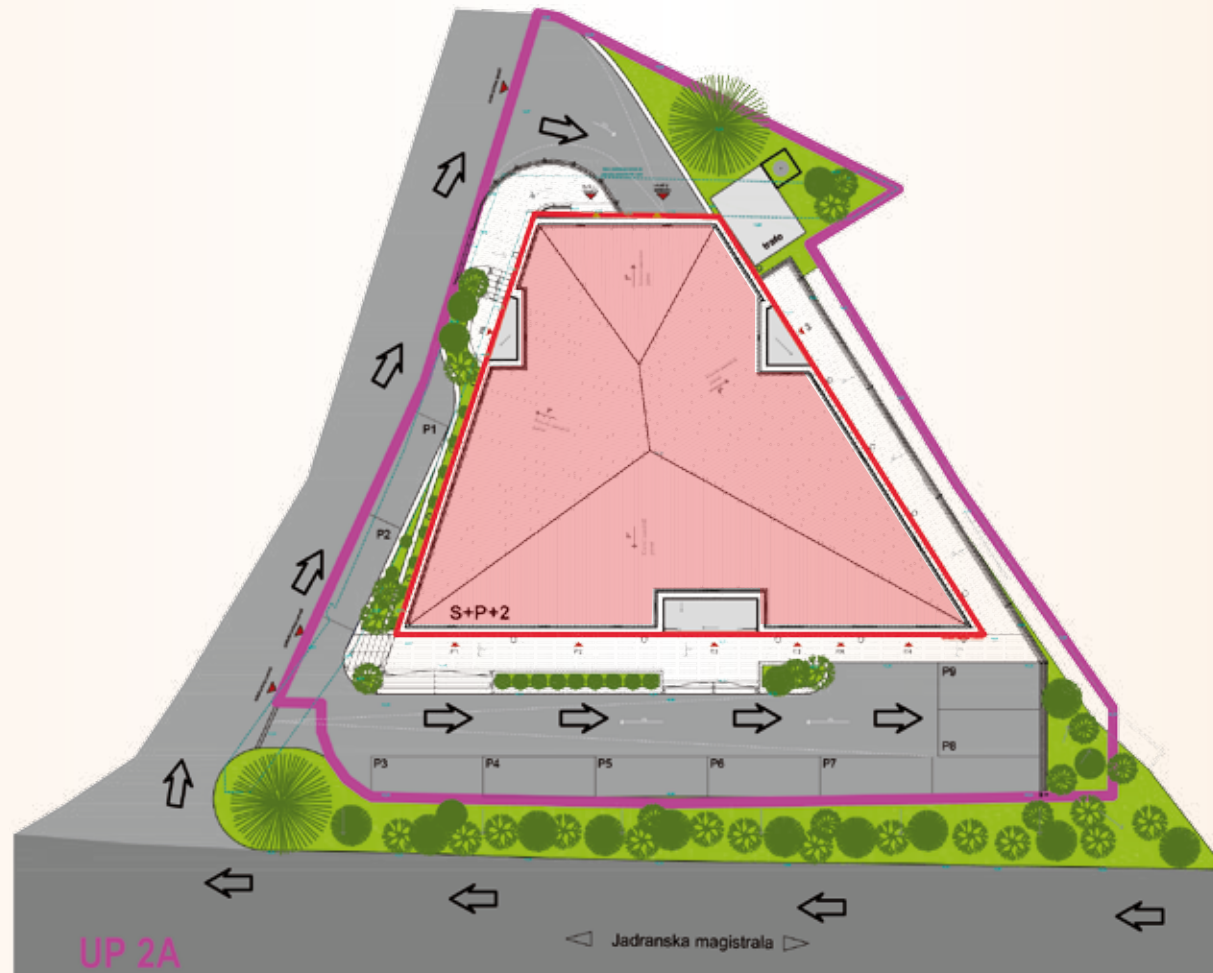

**PMC**  
INVEST  
TIVAT



  
**PMC**  
INVEST  
LIVEST



---

# PMC

---

I N V E S T

---

T I V A T

II Dalmatinske br.5  
85320 Tivat, Crna Gora  
Tel: +382 32 671 388  
Tel/Fax: + 382 672 388  
Mob: +382 67 642 758  
e-mail: [pmc@t-com.me](mailto:pmc@t-com.me)  
[www.pmc-invest.com](http://www.pmc-invest.com)